



बड़ौदा यू.पी. बैंक  
Baroda U.P. Bank  
Date 22-07-2024

RO/KAND/05/P&E/2024-25/94

**SHORT TERM TENDER NOTICE**  
(For Empanelled Furnishers & Interior Decorators only)

**INTERIOR DECORATION WORK IN NONAPUR BRANCH OF  
BARODA U.P. BANK**

**IMPORTANT DATES**

DATE OF ISSUE OF TENDER NOTICE	22.07.2024
LAST DATE AND TIME OF SUBMISSION OF TENDER	14.08.2024 up to 05:00 P.M.
DATE OF OPENING OF TENDER (FINANCIAL BID)	16.08.2024 at 03:00 P.M.

**Baroda U.P. Bank**  
Regional office Kanpur Dehat  
Nabipur, Jainpur Kanpur Dehat  
209311(U.P.)

  
Chief Manager

Date: 22.07.2024

## NOTICE INVITING TENDER

Sealed item rate short term tenders are invited on behalf of the Regional Manager, Baroda U.P. Bank, from the Furnishers & Interior Decorators having valid Empanelment with the Baroda U.P. Bank for the work of INTERIOR DECORATION WORK IN NONAPUR BRANCH OF BARODA U.P. BANK, Regional Office Kanpur Dehat.

1. Issue of tender documents : 22/07/2024 to 14/08/2024
2. Last date of receipt of tender documents : 14/08/2024 up to 5.00 PM
3. Date of opening of tender documents : 16/08/2024 at 03.00 PM
4. Place of submission & opening of tender : Baroda U.P. Bank, REGIONAL OFFICE, KANPUR DEHAT
5. Period for completion of work from order date : Maximum 30 days
6. Retention percentage : 10% (Ten percent) from final bill
7. Defect liability period : 12 months from the date of completion certificate issued by the Bank Architect.
8. Release of retention money : After 14 days from defect liability period.

## SUBMISSION OF TENDER

The tenders are to be submitted in a sealed envelope and clearly superscribed as "Tender for FURNISHING & INTERIOR DECORATION WORK IN NONAPUR BRANCH OF BARODA U.P. BANK, REGIONAL OFFICE, KANPUR DEHAT.

- Bids must be submitted through hand to hand or through registered Post.
- The bid must contain two Envelopes as per procedure given below

### FIRST ENVELOPE MUST CONTAIN ALL THE DOCUMENTS GIVEN BELOW:

1. Photo copy of PAN Number duly attested.
  2. Photo copy of GST Number duly attested.
  3. Registration certificate of both work i.e 'furniture & fixture work' and 'Electric & data cabling work
  4. All the documents should be self attested along with stamp of the Firm.
- IT MUST BE MENTIONED ON ENVELOPE "DOCUMENT SUBMITTED FOR BID OF FURNISHING & INTERIOR DECORATION WORK IN NONAPUR BRANCH".

### SECOND ENVELOPE MUST CONTAIN ALL THE DOCUMENTS GIVEN BELOW:

SECOND ENVELOPE MUST CONTAIN only price bid and nothing else.

- The price must be submitted on the prescribed format
- Price bid will not be accepted on any other format or document.
- It must be clearly mentioned "PRICE BID OF FURNISHING & INTERIOR DECORATION WORK IN NONAPUR BRANCH".

**BOTH TWO ENVELOPES MUST BE KEPT IN THIRD SEALED ENVELOPE AND SUPERSCRIBED "BID FURNISHING & INTERIOR DECORATION WORK IN NONAPUR BRANCH".**

### GENERAL INSTRUCTIONS TO TENDERERS

#### Time of Work Completion- One Month (From the date of work order)

1. The work as detailed in this tender shall be executed and completed in all respects within one month in accordance with the Tender Document, Bill of Quantities, Drawings and Instructions, to the satisfaction of the Architects and the Bank. A penalty of 1% per day of total work awarded will be imposed for delay in work completion.
2. The term "Contractor" shall mean the successful tenderer to whom the Contract shall be awarded.
3. The Contractor should quote the rates in figures and words. Any corrections or Over-writing should be initialed by the Contractor.
4. The Contractor should submit the tenders with seal, signature and date on each Page.
5. The Contractors should submit the cost of the main items as per tender specifications. Further modification after awarding of the contract shall be not allowed unless there is specific instruction

- by the Bank/Architect to change specifications.
6. The contract is time-bound and the works are to be completed within the time limit specified in the notice inviting tenders. This is a working office and the contractor has to work with no or minimum obstruction to its regular services.
  7. The decision of Employer and the Architect is final and binding.
  8. The contractor must submit registration certificate of both work i.e 'furniture & fixture work' and 'Electric & data cabling work' in separates envelope must be mention "Technical Bid for furnishing & electrical work".
  9. The contractor must submit the tender for both work i.e 'furniture & fixture work' and 'Electric & data cabling work', Partially filled tender will be rejected.
  10. **For Electrical fixtures and light points required as per drawings the contractor has to draw the wires from the existing positions of light points, power points wherever and if applicable. The contractor shall submit the certificate from electrical contractor holding required license/certification from directorate of electrical safety (U.P.)/competent authority of any other State.**

#### **TERMS & CONDITIONS**

1. Unless otherwise mentioned, all works are with no allowance for Lapse waste. Unless otherwise described or measured separately, price for all the items shall include all necessary straight & curved edges.
2. Any damage to the work before the site is handed over, is to be replaced or made good at the expense of the contractor to the entire satisfaction of the Architect/Bank.
3. Income Tax, Other Tax as applicable shall be deducted at source as per the Income Tax Act / Rules.
4. The quantities indicated are subject to change. The payment of the bill shall be made as per the actual measurement as certified by the architect but not exceeding the total value quoted in the tender form.
5. The Architect or any officer of the Employers will be free to inspect the work at the site during the period of execution. Any suggestion of change or modification to improve the quality of work will be carried out subject to prior approval of the competent authority of the employers and that of the Architect.
6. Incase of failure to take up the work even after accepting the work order, or leaving the work incomplete, or for defective work not rectified, or violation of the terms and conditions, the contractor will be de-panelled/blacklisted.
7. For any item of work not covered or any unforeseen items of work, payment will be made according to the rates approved for similar nature of work, the costing done by the Architect, as per current PWD schedule of rates, or as per analysis of material cost, labour rate and profit to the Contractor at 10%. The Contractor must obtain prior approval in writing before undertaking such additional works.

8. The tenderers shall sign each & every page of the tender documents including the drawings attached here to.
9. The amount is to be quoted in figures as well as in words. In case the rates quoted in words and in figures are in variance, the amount written in words shall be taken as final.
10. The Contractor shall make their own arrangement at their own cost for storing materials, plants, tools etc. The employers will not be liable for security of the Contractor's materials.
11. No tools or plants will be issued by the bank.
12. The Employer / Architect reserves the right to accept or reject any tender without assigning any reason whatsoever and the said decision shall be final and binding upon the tenderer.
13. In case of breach of contract by the Contractor for slow progress of works or any other claim of damage, the Employer or the Architect may have the power to rescind the contract without furnishing further reasons thereof.
14. The Architect shall have the power to ask the contractor to furnish the sample/ color / test certificate from any Govt. /Authorized agent for any materials used/ to be used in the Works, the expenditure of which is to be borne by the Contractor.
15. The Employer shall be not be liable for any damages or compensation payable as a consequence of any accident or injury to any workman or other persons in the employment of the Contractor or any sub-contractor.
16. On completion of the Works, all rubbish, debris, materials, tools, Laborers, etc. to be removed by the contractor from the site and the contractor will hand over the site clean & clear & in usable condition within 3 days of completion of the works. Failing this, the employer may
17. Dispose the materials at the cost of the contractor.
18. In case of any dispute, the matter will be referred to the Regional Manager, Baroda U.P. Bank, Regional Office Kanpur Dehat (UP).
19. Final Payment after completion of Project will be done with the certificate of Architect with deduction of retention money by the Bank.
20. The rates quoted in the tender shall exclude GST but include all excise tax, No escalation of rates will be allowed under any circumstances.

\*\*\*\*\*

**OF FURNISHING WORK FOR BARODA UP BANK BRANCH AT NONAPUR**

Sl.no	Description of items	Unit	Qty.	Rate	Amount
<b>4</b>	<b>Computerised Ledger &amp; Cash Counter</b>				
	Providing and placing in position ledger counter with top, vertical sides/dividers, skirting and fascia made out of 19mm thick water proof board with 1mm thick laminate (as/shade approved by the Architect) on all exposed surfaces. It shall also have 75mm x 40mm teak wood runners below the top and for footrest below. Every unit shall be provided with a side unit (size - W-500mm, H-750mm, D-500mm approx.), consisting of 150 mm deep drawer at top and a cabinet with open able/hinged shutter below.				
	. The fascia of drawer and shutter of cabinet below shall be made out 19mm thick water proof board with 1mm thick laminate (as/shade approved by the Architect) and sides and bottom of drawer shall be made out of 12mm thick water proof ply. The side unit shall have CAM locks, handles, guides, sliding units, hinges, magnetic catcher's etc. of approved make. Every unit shall be provided with a keyboard drawer unit (size - W-550mm, H-100mm, D-300mm approx.) below. The counter shall have 100mm deep fascia, below the top, in which keyboard drawer unit shall be adjusted.				
	It shall be made out 19mm thick water proof board with 1mm thick laminate (as/shade approved by the Architect) and sides and bottom of drawer shall be made out of 12mm thick water proof ply. The unit shall have CAM locks, handles, guides, sliding units etc. of approved make. The job shall include for 6mm x 6mm grooves in between sides and open able drawers and hinged shutters. All the exposed edges of water proof board and ply shall be provided with 6mm thick teak wood/hard wood lipping. All teak wood surfaces shall be with 1mm thick laminate, all complete to the satisfaction of the Architect.				
<b>a</b>	<b>High Level</b>	Rft	5		
	High level (two levels) Computerised cash counter.				
	Lower level top shall be 900mm wide and at 750mm level from floor & upper level top shall be 250mm wide (and at 1150 mm level from floor				
<b>b</b>	<b>Low Level</b>	Rft	12		
	Low level (two levels) Computerised ledger counter.				
	Lower level top shall be 900mm wide and at 750mm level from floor & upper level top shall be 150mm wide and at 900mm level from floor				
<b>5</b>	<b>Solid full height partition both side Laminated</b>	Sft			
	For unglazed partitions, no glazing to be given in partition/doors & other specifications as below 9.				
	(note : in case of false ceiling , the vertical TW members to be fixed with pucca ceiling but the area of partition payable will be below the false ceiling only.)				
<b>6</b>	<b>Partly glazed partition for cash cabins</b>	Sft	135		
	Decorative Grill (12mm thk)-hexagonal opening as per instruction of Bank's Engineer/Architect.) All exposed edges of Plywood shall be fixed with 1/8" C.P.Teak Lipping.				

	Providing and fixing of Cash Enclosures at height of 7'-4" with Anodized aluminium frame work, heavy sections (2mm thickness) of 2"x1.5", spacing of 2'0"x2'0" on bothsides and covered 6mm thick BWR plywood finished with 1mm thick laminate of blue, red colours for skirting & borders.Partition shall have provision for opening and 19mm BWR plywood tray for challan receiving purpose. Cost include aluminium grill and fixed with teak wood beading and duco paint. Cost also include 3 Nos of Solid core flush Doors with sizes of 2'6"x7'0", fixed in the partition. Door shall have teak wood beading and lipping with duco paint. Door finished with 1mm thick laminate of white colour for base and red & blue for skirting of approved pattern. Door shall have 8mm glass fixed with teak wood beading and duco paint. Rate to include hardware's like brass hinges, godrej three nos of night latch, door closure, door stopper and handles. Cost also include cash transaction opening shall be provided with door arrangements made with BWR plywood frame work finished by laminate, duco paint and locking system. Cost include wastages, transports, loading, unloading charges, labours, materials, tools, lead, lift and etc.Complete as per drawings and instructions of the Architect.				
	Solid till 4'-0" then Aluminium Decorative Grill height till 7'-0"then again solid				
7	<b>Partly glazed low height partition</b>	Sft	100		
	Same specification as in 1 but P/F half height partition of height 3'-6" with wooden laminate till 3'-0" and 1'-6" height 12 mm thick glass secured with D brackets including all hardware necessary with the same specs.as above.				
8	Providing and fixing Wall Panelling consisting of 2" x1 " 18 gauge section placed at 2'0x2'-0" horizontally and vertically with Unannodised Allumnium size 1.5mm thick of JINDAL/ INDAL confirming to ISI 303 standard as internal frame structure (as per site requirement) framework. The framing shall be fixed with with 8mm thick MR grade ply + 6 mm MDF of approved make firmly screwd to the aluminium frame on either side finished with 1mm th (high glossor texture) laminate as per approved sample. Item includes providing and fixing 12x12mm steem beech wood beading	Sft	120		
	making 6 mm grooves complete with polish & melamine spray finish on wood surface/grooves as per architectural drawings finished with 1mm thick laminate. Item includes providing and fixing 100mm wide skirting of 1mm thick mettalic laminate as per approved sample. Note: Surface measurement for one face & visible areas below false ceiling will be made for payment.				
9	<b>Manager's table + Side Table with 12mm thk glass top</b>	Each	1		
	Providing and fixing in position manager's table of size 6'-0"x2'6" as per drawing no. including side storage (credenza)by using 25 mm thick plywood for top and 18 mm thick plywood for all other horizontal and vertical members. Telescopic CPU stand/ready made keyboard tray shall be provided of approved model and make. Footrest made with TW member of size 4"x1 1/2 " finished with french polish.as per.				

	drawing shall be provided. Facia of side storage( credenza) shall be finished with 1 mm thick laminates as shown in the drawing and all other sides shall be finished with white enamel paint. The side storage (credenza) shall be provided with handles (stainless steel finish) and channels as per approval of the project consultant/bank . all exposed plywood surfaces to be finished with 1 mm thick . laminates of approved make and shade and all exposed edges of table top and ply verticals to have 1" x ¼" TW lipping , all exposed TW section to be melaminated and internal surfaces to have with 1mm thick laminate . Item ti include plywood boxing , all necessary hardware and fittings in stainless steel finish , lipping to all eds etc. complete in all respect.				
10	<b>Officer table + Side Table with 12mm thk glass top 5'-0"x2'-6")+Side table</b>	Each			
	<b>Same specification as above</b>				
11	<b>Full height storage / low height storage/ back storage (credenza)</b>	Sft	200		
	Providing and fixing in position full height storage / low height storage / back storage (credenza) as shown in drawing no. (8) (9) and (10) respectively using plywood of required thickness finished with 1 mm thick laminates as shown in the drawing and all other sides shall be finished with white enamel paint as detailed therein.				
	The storage units shall be provided with handles (stainless steel finish) as per approval of the project consultant/bank.				
	All exposed plywood surfaces to be finished with 1 mm thick. Laminate of approved make and shade and all exposed edges of plywood to have 1"x1/4" TW lipping . all exposed TW section to be melaminated in matching colour laminate and internal surfaces to have with 1mm thick laminate. item to include all necessary hardware an fittings in stainless steel finish ., Godrej multi purpose locks including magnetic ball catcher etc. complete in all respect.				
12	<b>12 MM THICK GLASS FOR CASH CABIN'S AND FRONT COUNTER</b>				
	Providing & fixing 12 m.m. glass in front of cash cabin and front counters with brass clamps including cut out for passing currency as/details.The edges of the glass to be machine polished.	Sq. ft.	45		
13	<b>Public settee</b> size 60"x 18"x18" Teak wood ,19 mm thick board, 1.00 mm thick mica GL/VL teak wood beeding including cost of all material, labour tools and plant etc. with 3" foam sleep well 32 density and covering cloth of superior quality.	No	1		
14	<b>Suggestion box</b>	No	1		
15	<b>Public writing wall stand</b> (including cost of fitting) 36"x16"x9" 19mm Board, 1.00 mm thick mica, teak wood beeding, Polish/Paint with fitting.	No	1		
16	<b>Notice Board</b>	1.00	NOS		
	Providing and fixing in position notice board (as per design) of size 900mm x 600mm x 150mm. The sides shall be made out of 19mm thick Premium Board (Green /Century) with 1mm thick laminate (as per shade approved by the architect) on all exposed surfaces.It shall have 12mm thick tack The front shall have 6mm thick float glass sliding shutter in two parts.				



	It shall also have 19mm wide two track aluminium channel for sliding arrangement, all around, along with locking arrangement. board (Make – Cellotex or equivalent) wrapped with stretched blazer cloth (Make- Raymonds), of Rs. 200.00 per Mt. (approx.) in colour and pattern approved by the Architect. It shall be fixed with help of kail/partal wood (sect. 19mm x 25mm) frame work. It shall be covered with 6mm thick Premium ply (Green /Century), on the back. All the exposed edges of water proof board and ply shall be provided with 6mm thick teak wood/hard wood lipping. All teak wood surfaces shall be melamine polished and other internal surfaces shall be painted with two coats of synthetic enamel over one coat of primer, all complete to the satisfaction of the Architect.				
17	Check drop box	No.	1		
18	<b>Center Table</b> with teak wood and 10mm glass ISI(size 48"x24"x18")	Sqft	1		
19	UPS PARTITION WITH BISON BOARD HT REST SPECIFICATION AS PER AS PER ABOVE PARTITION	Sqft	40		
				<b>Total Rs.</b>	-

**Not: GST Will be charged Extra**

**For – Bharat & Associates**

Sl. No.	Materials	Approved manufacturers / suppliers
1	Paint	I.C.I. ( Dulex - Duco) / Asian paints / Goodlac
2	Plywood	BWR- Century/Green/Archid only Premium
3	Wood preservative	BWR- Century/Green /Archid only Premium
4	False ceiling	Armstrong , Indian gypsum board
5	Laminates	Sunmica/ Archid/Century/Green
6	Screws	G.K.W./Nettle fold
7	Adhesive	Fevicol SH
8	Night latch	Godrej
9	Locks	Godrej
10	Aluminium door frame	Jindal
11	Glass	Modi/Asahi/Saint Gobain
12	Aluminium cladding	Eurobond/Altobond/Alukbond
13	Key board drawer	EBCO
14	Telescopic CPU stand	EBCO
15	Cable organiser ( wire manager)	EBCO
16	Vitrified tiles	Jhonsions Perlto
17	Venetion blind	Vista, Luxaflex

Note : Plywood mentioned in the drawings as well as in bill of quantities should be IS: 710 BWR- Century/Green only

**PROJECT - ESTIMATE FOR ELECTRICAL WORKS.**

**BANK - BARODA UP BANK**

**BRANCH-NONAPUR**

S.NO	PARTICULARS	Unit	Qty	Rate	Amount
	A -Electrical wiring (All switches to be Modular type - Anchor/ Havells or equivalent approved by architect) <u>Light &amp; Fan points</u>				
1	Supply & Installation of concealed point wiring using 600v grade 3x1.5 Sq.mm copper conductor PVC insulated wires (with proper R,Y,B color code ) pulled through heavy gauge 19mm PVC conduit pipe heavy duty concealed in wall/ floor/ panelling/ partitions or above false ceiling as per requirement including 2 Nos. 2.5 sqmm circuit wires from the relevant DB and also including 1.5 sqmm green color copper earth wire and switch plate, switches, etc. as approved by the Bank's Engineer/Architect. <b>All switch &amp; sockets shall be modular type complete with cover plate &amp; GI/ MS box.</b> The work shall also include for cutting chase for conduits and moulded boxes, if required, in the wall/ floor (Without damaging the building/wall) along with clamping the conduit at every 600mm interval & finally finishing the surface & matching the same with the existing surface.The rate should include the cost of all materials, labour, T&P, taxes & levies, scaffolding, shifting of furniture, carting away the debris and cleaning the floor etc.The job shall be complete & to the entire satisfaction of the Bank.				
a	Light points + AFF points including the cost of 6A switch	Point	28		
b	Ceiling Fan Point including the cost of 6A Switch along with electronic regulator	Point	6		
c	Wall Fan Point along with 6A switch	Point	7		
d	6A switch & Socket on SDb				
2	<b>RAW POWER POINT</b> Single Power Points - Supply & Installation of point wiring for Raw power plug points on workstations / table for computers using 2 X2.5 + 1x1.5 Sq.mm copper conductor PVC sheathed flexible wire pulled through heavy gauge 19mm PVC conduit pipe heavy duty concealed in wall/ floor/ panelling/ partitions or above false ceiling as per requirement. Each point consisting of 1 nos of 16A , 2/3/5 pin sockets & 1 No.16A Switch wired together forming one point. The earth wire of green color only. <b>All switch &amp; sockets shall be modular type complete with cover plate &amp; GI/ MS box.</b> The work shall also include for cutting chase for conduits and moulded boxes, if required, in the wall/ floor (Without damaging the building/wall) along with clamping the conduit at every 600mm interval & finally finishing the surface & matching the same with the existing surface.The rate should include the cost of all materials, labour, T&P, taxes & levies, scaffolding, shifting of furniture, carting away the debris and cleaning the floor etc.The job shall be complete & to the entire satisfaction of the Bank.	Point	6		
4	<b>UPS</b>				
A	Sub Main Wiring/ Cabling - : SITC of sub main wiring 4nos. 10 sq.mm Stranded copper wires for UPS Input from main incoming panel to incoming Db of UPS power input system etc. in 25mm dia PVC haevy duty conduit <b>complete to the satisfaction of the bank.</b>	JOB	1		
B	UPS Power Input System: SITC of 4way TPN Double door Db IP 42 horizontal Complete with 1no. Incoming 32A. TP MCB and 3 x 32A 2P MCB's to regulate supply for UPS complete in all respect as required and to the <b>satisfaction of the bank.</b>	Set	1		
C	Wiring for UPS Input & UPS Output (For both Critical 2Kva & Non- Critical 3Kva UPS) with 2x4.0sq.mm + 1x 1.5sq.mm stranded Cu. conductor (Finolex /Anchor /Skytone) to be laid in 19mm PVC pipe heavy duty/ Flexible pipe laid & concealed in-wall/ floor/ panelling/ partitions or above false ceiling as per requirement. The rate should include the cost of all materials, labour, T&P, taxes & levies, scaffolding, shifting of furniture, carting away the debris and cleaning the floor etc.The job shall be complete & to the entire satisfaction of the Bank.	JOB	1		
D	S/F of 32A 2P MCB in 2way metallic box including proper connectionbs thru lugs. Both the Db's shall be inter looped- Qty included in item 3. (2nos. For ATM and 2nos. For Branch)	Each	1		

E	UPS Output Power Distribution System: SITC of 12 way SPN Db Double door IP -43 Siemens make with 32A DP 10kA MCB and 09 nos. SP 10kA MCB complete in all respect and as required & to the satisfaction of the bank. Siemens/ L&T/ MDS/ Schnider	Set	1		
F	Input Wiring for UPS Db's with 2x4.0sq.mm + 1x 1.5sq.mm stranded Cu. conductor (Finolex /Anchor /Skytone) to be laid in 19mm PVC pipe heavy duty/ Flexible pipe laid & concealed in wall/ floor/ panelling/ partitions or above false ceiling as per requirement. The rate should include the cost of all materials, labour, T&P, taxes & levies, scaffolding, shifting of furniture, carting away the debris and cleaning the floor etc.The job shall be complete & to the entire satisfaction of the Bank.	JOB	1		
G	Supply & fixing of 4nos. 6A switches & sockets (Modular type c/w MS/GI box & cover plate) complete with computer point circuit wiring with 2x2.5sq.mm + 1x 1sq.mm stranded Cu. Single core Copper conductor (Finolex/Anchor/RPG) to be laid in PVC conduit 1" dia/ vertical drops heavy duty laid & concealed in wall/ floor/ panelling/ partitions or above false ceiling as per requirement	Per Node	6		
<b>5 MAIN INCOMING PANEL &amp; DISTRIBUTION</b>					
A	SITC of 100A Kit kats fuse unit 3nos in wooden patra complete with 100Amp. Neutral link complete in all respect as required. 1 No for Metre 1 no for Panel to Outer Side Of Wall (For Generator Connection)	Set	1		
B	Main Incoming Panel Supply, Installation, Testing & Commissioning of main distribution board panel fabricated of 18swg (powder coated) comprising of Indicator lamps 3 nos. Voltmeter & ammeter(one each) Rotary selector switches 2 nos for voltmeter & ammeter Busbar (each of RYB +N) copper 100 amp each 125 Amp MCCB(Siemens/ L&T/ ABB/ Schnider) incoming 3P adjustable 25kA Changeover TPN 100 amp for DG set (Havells/ ABB/ Sochomac) Outgoing 63A 3P MCB's - 6 nos. Outgoing 32Amp 2P MCB's - 6 nos. Earth bus bar 25x5mm GI strip - 2nos. At the bottom.	Nos.	1		
6	Supply Installation testing & commissioning of <b>XLPE insulated</b> Armoured Al.coductor cable between main panel & DB's & generator of required thickness of approved make Skytone/ Havells based on the load assessment & confirmation of the same with architect. This rates include cost of lugs at both the ends 3.5 x50 sq.mm cable from Meter to Kit kat to the main panel & Pole (Approx - 20 mtr) 4c x20 sq.mm cable from Main Panel TO LHS DB (Approx - 20 mtr) 4c x 20 sq.mm cable from Main Panel to RHS DB (Approx - 20 mtr) 4c x 20 sq.mm cable from Main Panel to Kikat (Generator) ( Approx - 40 mtr)	JOB	1		
7	Supply, installation, testing & commissioning of VTPN Db double door with MCB as incomer IP 42 complete in all respects for AC, PP and L & F as under - Siemens/ Hager/ Lagrand/ ABB				
A	RHS 6way VTPN db - Loaction RHS wall opposite Cash cabins (From entrance to Rear record room & Toilet area) - Siemens 8GB0406VRC or equivalent Incomer - 63A 3P MCB 10kA adjustable neutral to be directly connected to neutral bus 3no. 32A 1P-MCBs 10 KA - AC's - 2nos. RHS & 1rear 3no. 16A 1P-MCBs 10 KA - for single power points - 2 cash & 1 May I help You & 2nos. D/W 4nos. 10A 1P-MCBs 10 KA for L&F 4os. 6A 1P-MCBs 10 KA for L&F Blanking Plates - 2no. All connections to be terminated thru lugs	Each	1		
B	LHS 6way VTPN db - Loaction LHS wall behind advance (From LHS LV Cash to Mgr Rm)- Siemens 8GB0406VRC or equivalent Incomer - 63A 3P MCB 10kA adjustable neutral to be directly connected to neutral bus 4o. 32A 1P-MCBs 10 KA - AC's - 3nos. LHS & 1 Mgr Rm	Each	1		

	4no. 16A 1P-MCBs 10 KA - for single power points - ( LV cash, 2 CRE, 1Advance, 2 MR & 2 Router)				
	2nos. 10A 1P-MCBs 10 KA for L&F				
	2os. 6A 1P-MCBs 10 KA for L&F				
	Blanking Plates - 2no.				
	All connections to be terminated thru lugs				
8	Glow sign Board - Circuit wiring with 2x2.5sq.mm + 1x 1.0sq.mm stranded Cu. conductor (Finolex/Anchor/Skytone) to be laid in 19 mm PVC pipe heavy duty laid & concealed in wall/ floor/ panelling/ partitions or above false ceiling as per requirement. The rates should include the cost of all materials, labour, T&P, taxes & levies, scaffolding, shifting of furniture, carting away the debris and cleaning the floor etc.The job shall be complete & to the entire satisfaction of the Bank.	JOB	0		
	<b>E -EARTHING</b>				
9	For Main Panel - S/burying of Dual pipe technology (Pipe in Pipe) earthing electrode having GI 80mm O/D pipe with 25 micron coating, 3metres long. The space between two pipes to be filled with Highly conductive & Non corrosive chemical compound. The installation shall be thru earth auger. The vacant space between pipe & hole shall also be filled with compound all around. The job also includes S/F of GI strip clamp with two holes (with SS/GI bolts & nuts) on the electrode & taking two earthing leads of 25 x 5 mm GI strip (Assumed length of 10m - beyond 10m to be paid extra) upto Main panel complete in all respects with guaranteed E/N voltage of less than 3 volts and resistance less than 1 ohms. The distance between two earthing pits to be 10ft or more INCLUDING Earth wire 4 sq mm copper wire . Approx -80 mtr (2 FOR BRANCH & 1 ATM )	Per Icn.	2		
10	<b>F - FIXTURES &amp; FITTINGS</b>				
A	a) Supplying and fixing Philips make 36W LED FLAT PANEL after disconnection of existing fitting 2'x2' size in grid type false ceiling, 600x600 suitable for recess mounting, CRCA sheet, asthetic looking, or eqv Philips/havells	Each			
B	b) Supplying and fixing Philips make or eqv <b>10 W LED round type downlighter</b> (Philips/ wipro /Jaguar)	Each			
C	Supply installation testing and commissioning of 1*20watt Batten type tubular LED light fitting with LEDs, driver, diffuser, and housing complete in all respects in UPS room and record /wc/bath room /suitable place with complete in all respect with required color on need basis.	Each	22		
D	S/F of angle holder for bulbs including cost of 11w CFL lamp for Toilets	Each	2		
E	i) Supply & installation of wall bracket fan 450 MM (Heavy duty/ high speed) Make Bajaj/crompton greaves/havells/Orient (to be supplied after consultation with architect/Electrical Engineer as per approved drawing)	Each			
F	g) Supply & fixing of the 1200 mm 48") Sweep Ceiling fan (Orient PSPO/crompton greaves/havells) with downward rod(below false ceiling), canopy etc. including of PVC flexible copper wire.(white colour)( High speed) (Warranty Certificate is necessary)with downward rod, circular boxes, ball sockets, ceiling plates,suitable arm bracket etc. including connection with wire)White colour (WITH REGULATOR)	Each	6		
G	Supply & Fixing of fresh air fan 12" - Crompton Greaves/ Usha/ Khaitan/ Bajaj	Each	2		
H	e) Supplying and fixing LED strip 3000 K <b>24 watt</b> 5 mtr length with driver (Philips or Havells or Cormpton )	SET	0		
12	<b>I - DATA CABLING</b>				

A	Supply & Fixing of XL RJ 45 toolless information outlet with Duplex face plate with dual connectors Grey colour cat 6e including cost of supplying & laying CAT 6e (as directed by Architect from Server to Switch, Switch to computer I/O data socket as required complete in all respects) in 25mm dia rigid PVC conduit (including laying of GI draw wire complete with junction box, circular box, elbows, bends & other accessories as required by chase cutting on floor, wall, through partition or over false ceiling. The data cabling pipe should be laid at a minimum distance of 3ft from pipes laid down for power distribution) including interconnection with connectors as required complete in all respects.	Each	6		
B	Supply & fixing of 7ft Grey colour Patch chord Giga speed Systimax/ D link make	Each	6		
C	Supply & fixing of 3ft Grey colour Patch chord Giga speed Systimax/ D link make	Each	6		
D	S/F of 24Port Jack Panel fully loaded systimex make	Each	1		
E	S/F of 9 U wall mounted rack c/w fan etc as required	Each	1		
F	S/F of Cable Manager as required	Each	0		
GRAND TOTAL AMOUNT (gst extra)					
<b>List of approved materials</b>					
<b>Materials</b>			<b>Approved manufacturers/suppliers</b>		
1	MCCB	MDS legrands, ABB, GE, SIEMENS			
2	Changeover	Indo Asian/ HPL Socomec /			
3	Distribution board	MDS / Standard / Indo Asian / HPL			
4	MCB	MDS / Standard / Indo Asian / HPL			
5	Cable	Gloster / Rallison / Incab / CCI			
6	Copper wire	Finolex/anchor			
7	Switch / Socket / Call bell and accessories	Anchor / Havells / CPL / MDS			
8	Electrical Light Fittings / Fixtures Complete	Philips			
9	Wall Fan / Ceiling Fan / Exhaust Fan	Khaitan/Havells			

**ABSTRACT OF COST FOR THE BARODA UP BANK****AT NONAPUR BRANCH**

<b>S.No.</b>	<b>DESCRIPTION</b>	<b>AMOUNT (Rs.)</b>
<b>1</b>	<b>FURNISHING WORK</b>	
<b>2</b>	<b>ELECTRICAL WORK</b>	
	<b>TOTAL (Rs.)</b>	

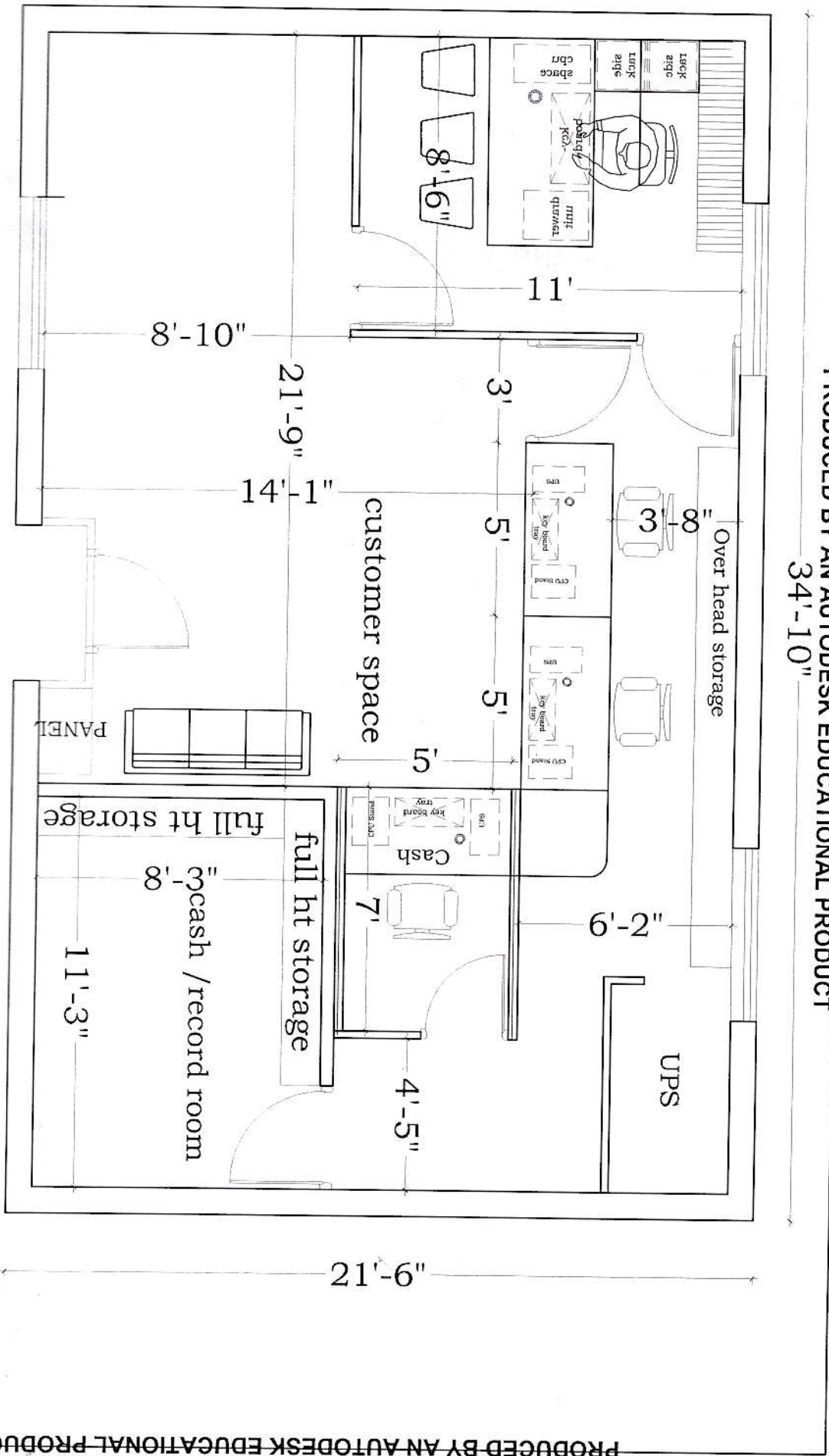

PRODUCED BY AN AUTODESK EDUCATIONAL PRODUCT  
34'-10"