



SHORT TERM TENDER NOTICE
(For Empanelled Furnishers & Interior Decorators only)

**FURNISHING WORKS FOR ATRAURA RAMBABA BRANCH REGION-
AYODHYA**

IMPORTANT DATES

| | |
|--|-----------------------------|
| DATE OF ISSUE OF TENDER NOTICE | 10.05.2024 |
| LAST DATE AND TIME OF SUBMISSION OF TENDER | 20.05.2024 up to 04:00 P.M. |
| DATE OF OPENING OF TENDER (FINANCIAL BID) | 21.05.2024 at 04:30 P.M. |

Baroda U.P. Bank
Premises & Equipment Department
Regional Office-Ayodhya
Baldev Niwas Compound, Acharya Narendradev Road Ayodhya-224001

Regional Manager

Date :10.05.2024

NOTICE INVITING TENDER

Sealed item rate short term tenders are invited on behalf of the Regional Manager, Baroda U.P. Bank, from the Furnishers & Interior Decorators having valid Empanelment with the Baroda U.P. Bank for the work of **FURNISHING WORKS** of **ATRAURA RAMBABA Branch District-Ambedkarnagar**.

1. Issue of tender documents : 10.05.2024 to 20.05.2024 up to 04:00 PM
2. Last date of receipt of tender documents : 20.05.2024 upto 4.00 PM
3. Date of opening of tender documents : 21.05.2024 at 4.30 PM
4. Place of submission & opening of tender : Baroda U.P. Bank, Regional Office Ayodhya.
5. Name of Architect : Gunjan and Associates (Mob: 9838818489)
6. Period for completion of work from order date : Maximum 30 days
7. Retention percentage : 10% (Ten percent) from final bill
8. Defect liability period : 12 months from the date of completion certificate issued by the Bank Architect.
9. Release of retention money : After 14 days from defect liability period.
10. Earnest Deposit Money :Rs 5000 in form of Demand Draft in favour of The Regional Manager, Baroda U.P.Bank Payable at Ayodhya.
11. Commencement of work : Within 7 days of issue of work order.
12. Period Of Completion : 30 days from the date of issue of work order. (A penalty of Rs 100/day will be imposed for further delay)

SUBMISSION OF TENDER

The tenders are to be submitted in a sealed envelope and clearly superscribed as

"Tender for FURNISHING WORKS of ATRAURA RAMBABA" branch and to be submitted at Baroda U.P. Bank, Regional Office, Baldev Niwas Compound, Acharya Narendradev Road, Ayodhya-224001 (U.P.)

ENVELOPE TO BE CONTAINED

Envelope shall contain the priced Tender Volume

GENERAL INSTRUCTIONS TO TENDERERS

1. The term "Employers" or "Bank" shall mean "Baroda U.P. Bank", or its authorized representatives at Baroda U.P. Bank, Regional Office Ayodhya, District-Ayodhya.
2. The term "Architect" shall mean "M/s.Gunjan and Associates" who is the Architect Consultant to the Employer for this project & having office at 141, Sainik Nagar, Raibareilly Road, Lucknow-226002 or its authorised representatives.
3. The term "Contractor" shall mean the successful tenderer to whom the Contract shall be awarded.
4. The "Works" shall mean the "FURNISHING WORKS AT ATRAURA RAMBABA BRANCH REGION-AYODHYA, DISTRICT-AMBEDKARNAGAR."
5. **The Contractor should quote the rates in figures and words. Any corrections or Over-writing should be initialed by the Contractor.**
6. The Contractor should submit the tenders with seal, signature and date on each Page.
7. The Contractors should submit the cost of the main items as per tender specifications. Further modification after awarding of the contract shall be not allowed unless there is specific instruction by the Bank/Architect to change specifications.
8. The contract is time-bound and the works are to be completed within the time limit specified in the notice inviting tenders. This is a working office and the contractor has to work with no or minimum obstruction to its regular services.
9. The decision of Employer and the Architect is final and binding.

TERMS & CONDITIONS

1. Unless otherwise mentioned, all works are with no allowance for Lapse waste. Unless otherwise described or measured separately, price for all the items shall include all necessary straight & curved edges.
2. Any damage to the work before the site is handed over, is to be replaced or made good at the expense of the contractor to the entire satisfaction of the Architect/Bank.
3. Income Tax, Other Tax as applicable shall be deducted at source as per the Income Tax Act / Rules.
4. The quantities indicated are subject to change. The payment of the bill shall be made as per the actual measurement as certified by the architect but not exceeding the total value quoted in the tender form.
5. The Architect or any officer of the Employers will be free to inspect the work at the site during the period of execution. Any suggestion of change or modification to improve the quality of work will be carried out subject to prior approval of the competent authority of the employers and that of the Architect.
6. In case of failure to take up the work even after accepting the work order, or leaving the work incomplete, or for defective work not rectified, or violation of the terms and conditions, the contractor will be de-panelled/blacklisted.
7. For any item of work not covered or any unforeseen items of work, payment will be made according to the rates approved for similar nature of work, the costing done by the

- Architect, as per current PWD schedule of rates, or as per analysis of material cost, labour rate and profit to the Contractor at 10%. The Contractor must obtain prior approval in writing before undertaking such additional works.
8. The tenderers shall sign each & every page of the tender documents including the drawings attached here to.
 9. The amount is to be quoted in figures as well as in words. In case the rates quoted in words and in figures are in variance, the amount written in words shall be taken as final.
 10. The Contractor shall make their own arrangement at their own cost for storing materials, plants, tools etc. The employers will not be liable for security of the Contractor's materials.
 11. No tools or plants will be issued by the bank.
 12. The Employer / Architect reserves the right to accept or reject any tender without assigning any reason whatsoever and the said decision shall be final and binding upon the tenderer.
 13. In case of breach of contract by the Contractor for slow progress of works or any other claim of damage, the Employer or the Architect may have the power to rescind the contract without furnishing further reasons thereof.
 14. The Architect shall have the power to ask the contractor to furnish the sample/ color / test certificate from any Govt. /Authorized agent for any materials used/ to be used in the Works, the expenditure of which is to be borne by the Contractor.
 15. The Employer shall be not be liable for any damages or compensation payable as a consequence of any accident or injury to any workman or other persons in the employment of the Contractor or any sub-contractor.
 16. On completion of the Works, all rubbish, debris, materials, tools, Laborers, etc. to be removed by the contractor from the site and the contractor will hand over the site clean & clear & in usable condition within 3 days of completion of the works. Failing this, the employer may
 17. Dispose the materials at the cost of the contractor.
 18. In case of any dispute, the matter will be referred to the General Manager, Baroda U.P. Bank, Head Office Taramandal, Gorakhpur(UP).
 19. Final Payment after completion of Project will be done with the certificate of Architect with deduction of retention money by the Bank.
 20. The rates quoted in the tender shall exclude GST but include all excise tax, octroi & other taxes, no escalation of rates will be allowed under any circumstances.
 21. If the work is not completed within the stipulated time, a penalty of Rs 100/day will be imposed till the completion of works.

ARCHITECT

Gunjan and Associates
141, Sainik Nagar, Raibareilly Road
Lucknow-226002

Gunjan and Associates
Architects, Engineers, Interiors
& Landscape Designers

141, Sainik Nagar, Raibareilly Road, Lucknow-226002

Phone: 0522-3553324, 9839018489, 9838818489

E-mail: studio@gunjanandassociates.com

URL: www.gunjanandassociates.com

Bill of Quantity for Furnishing works for Baroda U.P. Bank

Branch at Atraura Rambaba

Region - Faizabad

1.No offsite prefabrication shall be allowed in any case. All fabrication shall be done at the site after getting the materials inspected by the architect

2.No payment shall be made for any in completed or unsatisfactory work

3.The Contractor should strictly follow the Booklet requirements of the Bank

including the detailed drawings in the booklet. Any discrepancy between the booklet and the Specifications below should be brought to the notice of the Architect.

4. List of material to be strictly as per the booklet.

5. Cable Managers to be provided in the tables and Counters wherever required.

6. All underframe should be properly treated with antitermite and waterproofing material

7. All Locks in the drawers and doorsetc. should be of Godrej

8. All keyboard Trays and Drawers to be on Channel Sliding Mechanism.

9. The contractor to follow the banks colour Coding. Any other specified colour to be superceded by the Banks Colour code.

10. All board to be BWP. Of approved brand and if written BWR it should be superceded by BWP board/ply.

| S.No. | Description of item | Unit | Qty. | Rate | Amount |
|-------|--|--------|--------|------|--------|
| 1 | Branch Manager Table with Side Table. | NOS. | 1.00 | | |
| | Size -5'-6" (L) X 2'-6" (W) X 2'-6" (H) Providing and placing in position table made of phenol bonded 19mm thick commercial board with top front and sides finished in 1.0 mm Thick laminate and 12mm thick toughened glass on top. The front facade of the table to have 6mm thick and 29mm wide moulding. Every table shall be provided with a key board, drawer, and a cabinet with a shutter below W-375mm, H-750mm, Depth- 500mm. The storage unit shall consist of provision for C.P.U. 600X250 size Keyboard to be made of 19 mm thick commercial board and finished Drawers and a cabinet with a shutter below W-375mm, H-750mm, Depth-500mm. shall consist of 12 mm thick commercial board for bottom, sides and back of 19mm thick phenol bonded commercial board with laminate in front and shall slide on tray system provision (sliding mechanism). | | | | |
| | All the units shall be provided with all the necessary hardware as approved by the Architect. such as knobs, handles, etc. All unexposed surfaces to have two coats of synthetic enamel paint with primer and base, all complete, specifications and directions of the engineer in charge. | | | | |
| 2 | Cash Cabin Partition | Sq.ft. | 162.48 | | |

| | | | | | |
|----------|---|----------------|---------------|--|--|
| | Cash cabin partition made of both side 6.00mm commercial ply on kail wood frame section 50x35mm and 1.00 mm mica, aluminum grill partition and mica laminated aluminum grill door complete with locks, top of cash cabin covered by aluminum grill. Including all locks & handles, door closer. Size of cash cabin 5.6 ft x 7 ft x 7.5 ft, and include Front of the cash Cabin to be glazed with 12 mm thick etching glass fixed in position by teak wood members complete to the satisfaction of the architect. The cash cabin to have night latches as per direction of the architect. This would also include decorative aluminium jali at the top of cash cabins fixed with teak wood members. (CASH CABIN TOP IS NOT INCLUDED IN THE MEASUREMENT). | | | | |
| 3 | Cash Counter | Rft. | 5.50 | | |
| | Bank counter of approved design for cashier made of 19.00 mm commercial block board and mica 1.00 mm thick of approved brand and colour on front customer top and writing desk. Height of counter from customer side 114cm (45"). width of writing desk 75cm. (30") with provision of cupboard after every 1.20 mts made of 19.00 mm block board with 1.0 mm sunmica pasted on both side (inner and outer), and teakwood beading complete with quality polish finish. Mica pasted on both sides external & internal including all locks & handles with door closer. | | | | |
| 4 | Front Counter | Rft. | 7.00 | | |
| | Front counter made of 19.00 mm block board with table top at the height 75 cm and 80 cm wide sunmica 1.0 mm on top and cup board and sliding key board with provision of fixing of glass in front. Mica pasted on both sides external & internal including all locks & handles | | | | |
| 5 | Cash Cabin-Aluminium Grill Top with teak Decorative Grill Partition). | SQFT | 40.00 | | |
| | Providing and fixing of Aluminium grill work in cash counter top with all necessary fixing support of 'L', 'H' and 'C' aluminium sections and etc. Cost include 'L', 'H' and 'C' aluminium sections, hardwares, tools, wastages, lead, lift, labour charges, loading, unloading charges, cutting, transport and etc. Complete as per instructions of the Architect. | | | | |
| 6 | 12 MM Glass on Front Counter & Cash Counter | Sq. ft. | 35.00 | | |
| | 12 MM float glass with rounded edges with etching as per the requirement of bank for Front counter (Height: 60 cms) (With teak wood frame 70 cm). | | | | |
| 7 | Low Height Partition | Sq.ft. | 120.00 | | |

| | | | | | |
|-----------|---|---------------|---------------|--|--|
| | Low Height Partition made of both sides 6mm commercial ply laminated with 1.0mm sunmica on Cheed Wood frame section 50.00 mmx30.00 mm with glass of 12 mm and door made of 100 x 25 cheed wood frame and ply and mica including all locks, handles & bolt, quality polish etc.Sample bank's low height partition. (LOW HEIGHT PARTITION HEIGHT 4'-0") | | | | |
| 8 | Storage (Low Height) | Sq.ft. | 30.00 | | |
| | Size-2'-6" highX 1'-6" deep | | | | |
| | Ply Wood -19.0mm thick board for side top and door & back 6.0mm IS 303 with shutters, shelf 19.0mm ply | | | | |
| | Shelf -19.0mm thick MR Grade IS303 ply | | | | |
| | Handle -Brush finish stainless steel | | | | |
| | Lock -Vijayan/Godrej | | | | |
| | Internal surface zinc oxide polish and other required accessories instructed by Bank's Engineer/Architect. | | | | |
| 9 | Column / Wall Panelling /Meter Boxing | Sq.ft. | 185.00 | | |
| | Providing & fixing in position 2"x 2" kailwood frame and finished with 6 mm thk.Commercial ply on both sides with 1.0 mm thk. Laminate on top as per instruction of the Architect. column panelling only 7.5' height | | | | |
| 10 | Notice Baord | No. | 1.00 | | |
| | Notice Board made of 19.00 mm board (size: 3'-0"x3'-0") laminated sides andcovered by good quality Cherry Colour Velvet with attached Cheque Writing Desk (6"x6"x9") with attached Two Battens for Support, Sunmica Pasted on all sides. | | | | |
| 11 | Writing Desk Including Suggestion Box and Cheque Drop Box | No. | 1.00 | | |
| | Writing ledge of 19 mm Phenol bonded board as/design on 19 mm thick with pockets for slips of 6mm glass machine polished with seperators completed to the satisfaction of the architect and the Drawing. The Writing ledge includes a Suggestion box below, cheque drop box and a notice board above complete to the satisfaction of the Architect. | | | | |
| 12 | Hydraulic Door Closure. (to be Godrej) | No. | 1.00 | | |
| | Providing and fixing of hydraulic door closure (Make-Godrej, Product Code-4539 or equivalent) for doors. It shall incorporate the following - | | | | |
| - | Body manufactured from Aluminium extruded alloy machined to extreme accuracy. | | | | |
| - | Rack and Pinion-made of machined alloy steel duly heat-treated. | | | | |
| - | Adjustable closing speed. | | | | |
| - | Suitable for right hand and left hand opening doors. | | | | |
| - | Suitable for door / frame mounting. | | | | |

| | | | | | | |
|---|--|--|--|--|--|--|
| - | Suitable for door weight up to 60 kgs. | | | | | |
| - | Suitable for 180 / 100 degree door opening. | | | | | |
| - | All complete to the satisfaction of the Architect. | | | | | |
| | | | | | | |
| | Total | | | | | |

Note: All rates are excluding G.S.T.

For GUNJAN & ASSOCIATES

Gunjan Kapur
(Ar. GUNJAN KAPUR)
 PROPRIETOR

Ar. Gunjan Kapur

for Gunjan & Associates

BARODA U.P BANK**LIST OF MATERIALS OF APPROVED BRAND AND/OR MANUFACTURER**

1. The contractor shall use materials in their work subject to inspection, prior to dispatch, by Owner or his authorized representative of any materials not otherwise specified, shall be in accordance with the following list. All materials not otherwise specified shall be in accordance With the latest Indian Standard Specifications, where such exists with prior approval of Owner /Architects. The contractor shall be bound to offer sample of materials, which are Claimed to be conforming to I.S Specification, for testing at an approved testing laboratory.
2. Contactor shall purchase all materials from the makers or their authorized stockist only. Necessary documentary evidences must be produced to the Owner' or their authorized Representative on demand.
3. Contractor shall be bound to supply items or any make of the items as per the choice of the Owner/ Architects.

A CIVIL / FURNISHING WORK

| S.No | Description | Approved Brand/ Manufacturer |
|------|--|--|
| 1. | Cement | M/s ACC, M/sPrism ,M/s Jaypee |
| 2. | Wood | Kail wood |
| 3. | Polish | MRF Polyurethane |
| 4. | Termite treatment | Chloroporyphos 20% concentration / Dusban /Terminator pidlite make |
| 5. | Soft Board | Celotex |
| 6. | False Ceiling and Sections | Grid Tiles ---Armstrong, St Gobain Gypsum India, |
| 7. | Aluminium sections | Hindalco, Jindal, Indal |
| 8. | Vitrified Floor tiles | SOMANY,ASIAN,JOHNSON |
| 9. | Block boards / Plywood/Flush doors | M/s Duro (BWP),M/s Century (BWP), M/s Green Mica (BWP), No alternate brands from the same manufacturer allowed |
| 10. | Laminates | M/s Green, M/s Merino, M/s Century, M/s Green Mica1.0 mm thick only. |
| 11. | Hardware-(Aluminium) | Approved design, brand, quality & manufacture Allowed |
| 12. | Hardware | ALL HARDWARE TO ONLY GODREJ |
| 13. | Drawer/ cabinet Handless/locks | Dorset / Kitch/ Godrej/ hettich |
| 14. | Magnet Catcher | Supreme, Excel |
| 15. | Drawer / cabinet shutter Accessories | Ebbco, Hettich, Hafele |
| 16. | Synthetic Enamel Paints, Distemper or Plastic paint Best quality of make as approved | Asian Paints Ltd), Berger Paints (India) Ltd.(Luxol), ICI, Nerolac. |
| 17. | Venetian blinds/ verticals | Vista/sun |
| 18. | Glazing | M/s Modiguard, M/s asahi india, Saint Gobain. |
| 19. | Door Closer/ floor spring | Godrej, Dorma, Ozone |
| 20. | Glue Adhessive | Fevicole, Century |
| 21. | Door handles/ Locks | Godrej |
| 22. | Screw | Excel GKW |
| 23. | Glass brass bracket | Flora, Perfect |
| 24. | POP bag or readymade work | Diamond (Super fine quality) |
| 25. | GI section for Partitions, Panel, false ceiling | Same Company as of Gypsum Bard or Mineral Fibre tiles |
| 26. | Film | Alkor, Garware, 3M |
| 27. | Plants | |
| 28. | Wire management holes | Twinkle |
| 29. | Cement Board | E board, Bison, |
| 30. | Vitrified floor tiles adhesive / Grout | Bal Endura, Dr. Fixit Fevimate XL with Polymer Modified Mortar, ROFF Granite tile adhesive |

| | | |
|-----|--------------------------|---------------------------------|
| 31. | Texture | Spectrum , Heritage, Acro paint |
| 32. | Upholstery | Raymonds |
| 33. | Sanitary Fixtures | Cera, Hindware, Parryware |
| 34. | GI Pipes and accessories | TATA |
| 35. | CI Pipes and accessories | NECO |
| 36. | Plumbing Fittings | Jaquar Continental series |
| 37. | Ceramic Tiles | Kajaria (High Lighter Concept) |
| 38. | Chairs / Sofa | Godrej, Delite / Debono |

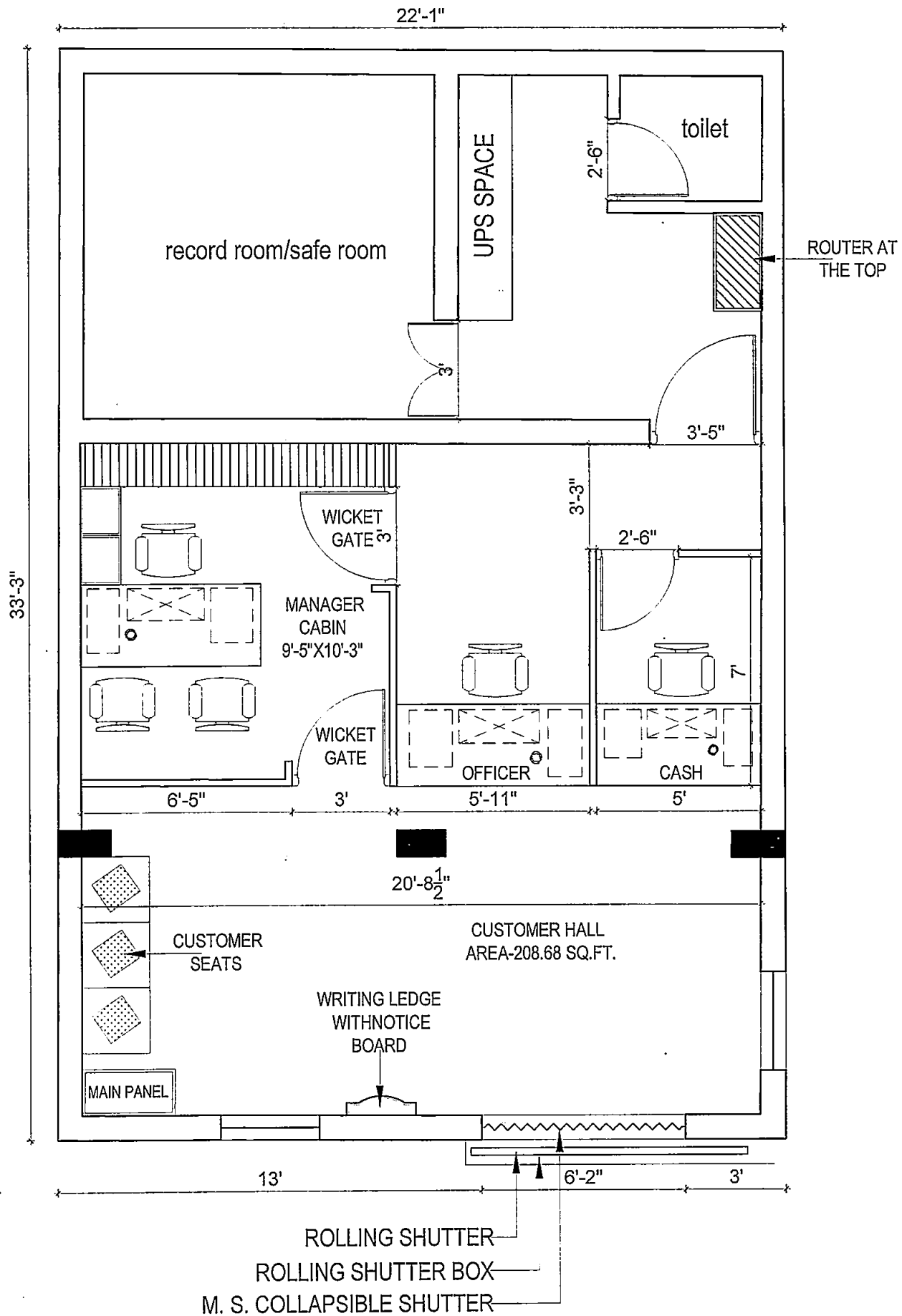

DRG. TITLE:-

REVISED LAYOUT PLAN FOR
BARODA U.P. BANK,
ATRAURA RAMBABA,
FAIZABAD

Drg. Title

REVISED LAYOUT
PLAN

North



Date

JAN -2022

Drawn By

GUNJAN & ASSOCIATES

ARCHITECTS, ENGINEERS, INTERIOR

AND LANDSCAPE DESIGNERS.

141, TANK NAGAR, LANE NO-9

RAE BAPELI ROAD LUCKNOW-226002

Phone: +91 9839018489, 9838818489

E-mail: -studio@gunjanandassociates.com

E-mail: -arun.jan@yahoo.com

URL: -www.gunjanandassociates.com